

HP60 planetary gearhead



PARVALUX®

www.parvalux.com

complete range at-a-glance

	Type code	Mechanical rating ^a (Nm)	Radial load (N)	Axial load (N)	Shaft Orientation	DC permanent magnet (PM)						AC induction (SD)						AC/DC series wound (SD)						DC shunt	
						Power ^a (Watts)		Speed (rpm)		Torque ^a (Nm)		Power ^a (Watts)		Speed (rpm)		Torque ^a (Nm)		Power ^a (Watts)		Speed (rpm)		Torque ^a (Nm)		Power ^a (Watts)	
						Min	Max	Min	Max	Min	Max	Min	Max	Min	Max	Min	Max	Min	Max	Min	Max	Min	Max	Min	Max
motor only	-	-	-	-	In-line	7.5	562	1500	5000	0.05	1.1	3.7	250	900	2800	0.025	1.3	10	190	2000	6500	0.04	0.36	10	150
worm	S	4.5	69	35	90°	7.5	90	21	970	0.2	4.0	3.7	120	13	680	0.06	4.5	38	50	43	960	0.2	2.3	38	50
	M	11.8	132 ^b	88 ^c	90°	23	280	21	970	0.5	11.7	10	190	12	680	0.36	11.8	38	150	42	970	0.2	6.4	38	150
	L	22	177 ^b	132 ^c	90°	33	450	25	780	0.9	18.7	95	250	15	546	1.6	17	50	150	33	780	0.9	11.3	60	150
	LS	22	314	196	90°	33	450	25	780	0.9	18.7	95	250	15	546	1.6	17	50	150	33	780	0.9	11.3	60	150
	G	50	491	294	90°	80	450	20	320	4.6	45.1	-	-	-	-	-	-	-	-	-	-	-	-	-	-
double worm	SS	5.9	54	35	90°/in-line	7.5	60	0.5	150	0.8	5.9	3.7	120	0.32	40	0.34	5.9	15	50	1	80	1.8	5.9	38	50
	MM	11.8	88 ^b	88 ^c	90°/in-line	23	60	0.3	59	5	11.8	8	190	0.5	30	1.1	11.8	10	125	1	80	3.4	11.8	10	150
in-line double worm	SIW	11.3	78	49	in-line	7.5	90	1	235	0.6	11.3	8	60	1	164	0.4	11.3	10	38	1.5	176	0.5	11.3	10	38
	MIW	28	265	132	in-line	23	120	1	235	1.7	28	8	120	1	164	0.5	28	10	75	1.5	176	0.5	28	10	95
	LIW	45	353	196	in-line	33	200	1	108	4.7	45	35	190	1.1	75	4.3	45	30	95	1.6	81	2	45	50	125
in-line spur	SIS	7.9	88	44	in-line	7.5	90	5	182	0.9	7.9	8	60	3	127	1.24	7.9	10	38	6.6	136	1	7.9	10	38
	MIS	45	216	137	in-line	33	200	15	623	1	37	35	190	14	436	1	45	30	95	20	467	0.8	23	50	125
	LIS	74	265	177	in-line	23	280	4	667	1	86	10	190	2.6	467	1	100	30	95	6	500	1	74	50	125
worm spur	SWS	11	177	112	90°	7.5	60	1	101	1.5	11	8	25	1	71	1.9	11	15	38	1.8	76	1.9	11	15	38
	MWS	45	353	177	90°	7.5	90	1	149	1	45	10	60	0.65	106	1.1	45	25	50	1.4	150	1.8	45	25	50
	LWS	100	446	226	90°	23	450	0.4	80	4	100	8	190	0.22	90	1	100	38	125	0.9	80	3.5	100	38	150
	GWS	250	667	353	90°	60	450	0.5	71	16	250	55	250	0.4	50	11	250	-	-	-	-	-	-	-	-
planetary	HP60	40 ^d	725 ^d	225 ^d	in-line	23	450	1	1000	0.52	30	-	-	-	-	-	-	-	-	-	-	-	-	-	-
						DC permanent Magnet						AC induction						AC/DC series wound						DC shunt	
motor construction						Permanent magnet stator, wound rotor with commutator						Wound stator, aluminium cage rotor						Low resistance wound stator, wound rotor with commutator						High resistance wound rotor	
insulation class						F						F						F							
supply voltage						DC from 12V to mains voltage						AC 1 or 3 phase mains voltage						AC or DC up to mains voltage						DC up to 24V	
ingress protection						IP22 / IP54						IP20 / IP50 / IP54						IP20 / IP23 / IP50 / IP54						IP20 / IP23	

a: for S1 duty cycle (continuous operation); figures for intermittent operation may be higher, call for details | b: approx. 70% higher when supplied with base | c: approx. 20% higher when supplied with base | d: for 4-pole

EMD
DRIVE SYSTEMS



RE90-146GB12 'rare-earth' unit for floor cleaning application



Bespoke designed high-load unit for stair lift application

Designed for
application OEM
solutions

Shunt wound (SD)				Standard options													
Speed (rpm)		Torque ^a (Nm)		fixing base (B)	shaft length (mm)	shaft dia. (mm)			shaft output			flange PCD (mm)			International standard flanges		
Min	Max	Min	Max			single	double	hollow (H)	flat	keyway	custom	standard	optional (F)	3-point (3P)	IEC	NEMA	metric
2000	5000	0.05	0.38	-	-	○	○	-	-	-	-	●	-	-	○	○	○
43	960	0.2	2.3	-	29	9	9	-	●	○	○	41.3	-	42	-	-	-
28	970	0.2	6.8	○	52	12	12	8	○	●	○	47.6	80	50.8	-	-	-
33	780	1	11.3	○	51	15	15	15	○	●	○	57.1	100	72	-	-	-
33	780	1	11.3	-	51	25	25	15	○	●	○	-	-	-	-	-	-
-	-	-	-	-	75	25	25	15	○	●	○	-	-	-	-	-	-
1	80	2.8	5.9	-	29	9	9	-	●	○	○	41.3	-	42	-	-	-
1	80	3.4	11.8	○	52	12	12	8	○	●	○	47.6	80	50.8	-	-	-
1.5	176	0.5	11.3	●	29	9	-	-	●	○	○	41.3	-	-	-	-	-
1.5	176	0.5	28	●	52	12	-	-	○	●	○	47.6	-	-	-	-	-
1.6	81	4	45	●	51	15	-	-	○	●	○	57.1	-	-	-	-	-
6.6	136	1	7.9	●	25.5	10	-	-	●	○	○	41.3	77.2	-	-	-	-
20	467	1.3	30	●	51	14	-	-	○	●	○	48	-	-	-	-	-
6	500	1	74	●	51	15	-	-	○	●	○	70	-	-	-	-	-
1.8	76	1.9	11	●	32	10	10	-	●	○	○	-	-	-	-	-	-
1.4	150	1.8	45	●	51	14	14	-	○	●	○	48	-	-	-	-	-
0.9	80	3.5	100	●	51	15 ^e	15 ^e	-	○	●	○	70	-	-	-	-	-
-	-	-	-	●	76	25	25	15	○	●	○	75	-	-	-	-	-
-	-	-	-	-	30	15	-	-	○	●	○	45	-	-	○	○	○
Shunt wound				Optional extras													
Distance wound stator, or with commutator F				Tachogenerator; encoder; terminal box; brake; speed reducer; controller													
				Customisation options													
				Shaft; spindle; paint finish; fixing arrangements; non-standard ratios; Ingress Protection (IP) rating; gear material; lubricant; insulation class													
to mains voltage				Design options													
IP23 / IP50 / IP54				Bespoke motor-gearbox design and manufacture service call for details													
Stage assembly e: 17mm diameter shaft available with ratios 115:1 and 56:1 f: maximum KEY: ○ as standard ○ optional																	

stage assembly | e: 17mm diameter shaft available with ratios 115:1 and 56:1 | f: maximum | KEY: □ as standard ▢ optional

contents

Gearbox data	
HP60	4
Flange options	5, 6
Geared motors	
PM1HP60	7
PM2HP60	8
PM6HP60	9
PM60HP60	10
PM10HP60	11
PM11HP60	12
PM3HP60	13
PM4HP60	14
PM5HP60	15
PM50HP60	16
Contacts	17

E&OE (errors and omissions excepted); in line with our policy of continuous improvement all data is subject to change. All drawings and product representations enclosed herein are not to scale.

engineering reliability into every product for over sixty years

Parvalux is one of Europe's largest specialist designer-manufacturers of fractional horsepower (sub 1kW) AC/DC products for industrial and commercial application. Based in Bournemouth UK, the company manufactures over 5000 standard products and bespoke solutions for OEM customers. A privately run business, Parvalux has offices in New York, Paris, Frankfurt, Warsaw and Johannesburg.



PM63-50GB9 robust unit for wheelchair application



PM50-63GB11 lightweight plastic unit for golf trolley application



American National Accreditation Board and British Standards Institute

HP60 gearbox

PARVALUX®

TYPE	60mm cylinder planetary
OPERATING TEMPERATURE	-30°C to +120°C
AMBIENT TEMPERATURE	-30°C to +40°C
PROTECTION	IP65
LUBRICATION	Grease lubricated for life
ROTATION DIRECTION	As input direction
RATED INPUT SPEED	4000 rpm
PRESS FIT MAX FORCE	750 N
GEARS	Alloy steel or composite on request
INPUT FLANGE	Direct fit only (servo coupling on request)
SERVICEABLE LIFETIME	1,000 hours at full load at rated input speed, rising to 15,000+ hours for low-wear applications



stage 1 HP60 gearbox pictured with metric flange

Stages	Dimension 'A' (mm)	Efficiency (%)	Continuous Torque (Nm)	Peak Torque (Nm)	Backlash (Arcmin)	Weight (kg)	Radial Load (N)	Axial Load (N)
1	69.5	95	5	10	22	1.02	250	75
2	82	87	15	25	32	1.25	400	125
3	94.5	80	30	40	42	1.54	550	175
4	107	74	30	40	52	1.78	725	225

standard ratios

(other ratios available on request)

1 stage	2 stage	3 stage	4 stage
4	16	64	256
6	24	96	384
	36	144	576
		216	864
			1296

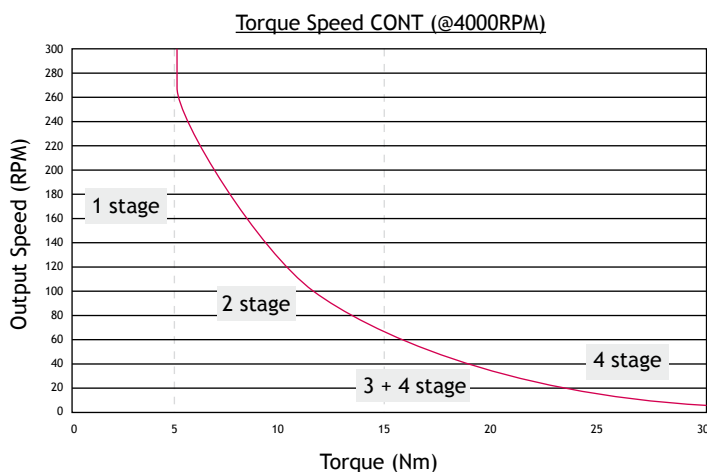

Option: servo-coupling (available on request only)

Available with a standard clamped-segment servo-coupling to enable fitting and re-fitting to a motor. Zero backlash at point of coupling.

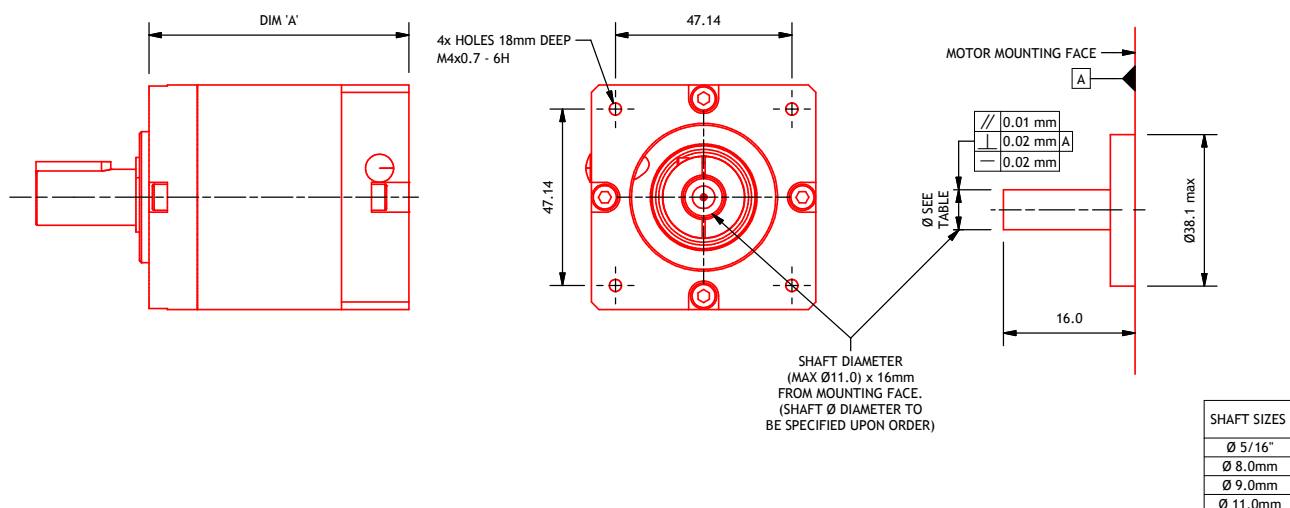

HP60 flange options 1

Parvalux standard flange/mount

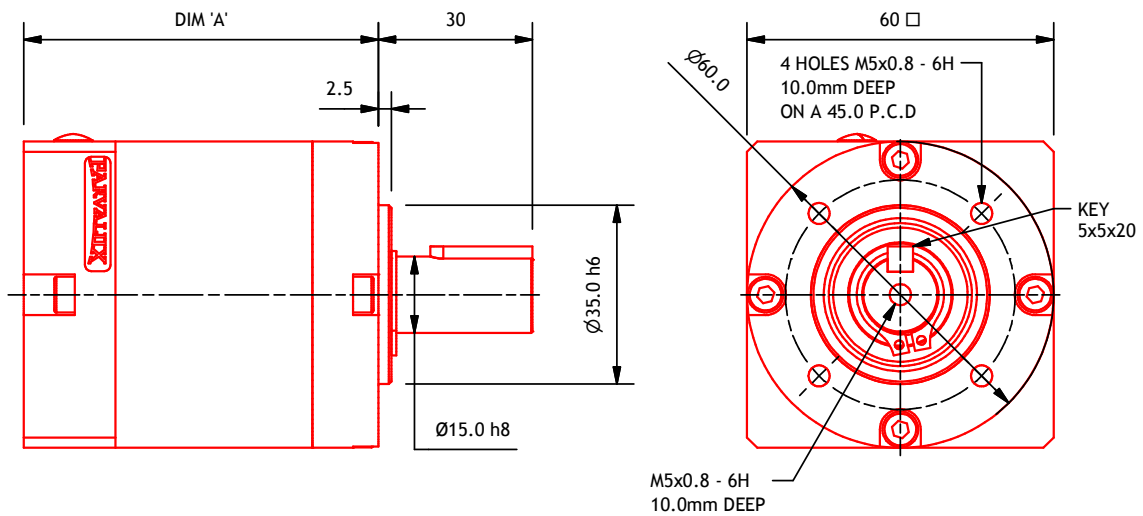

Metric flange/mount

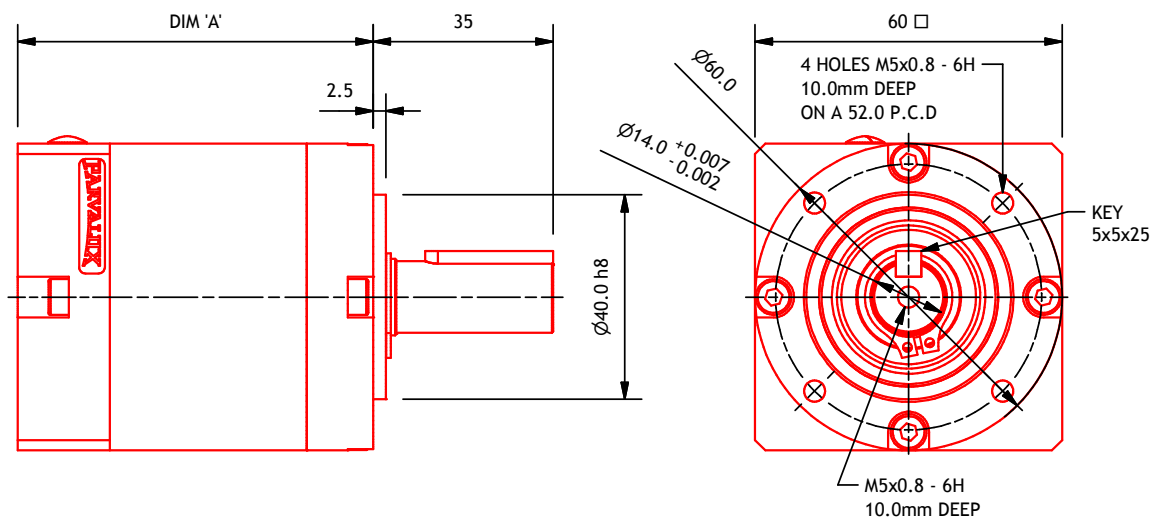

NEMA standard flange/mount

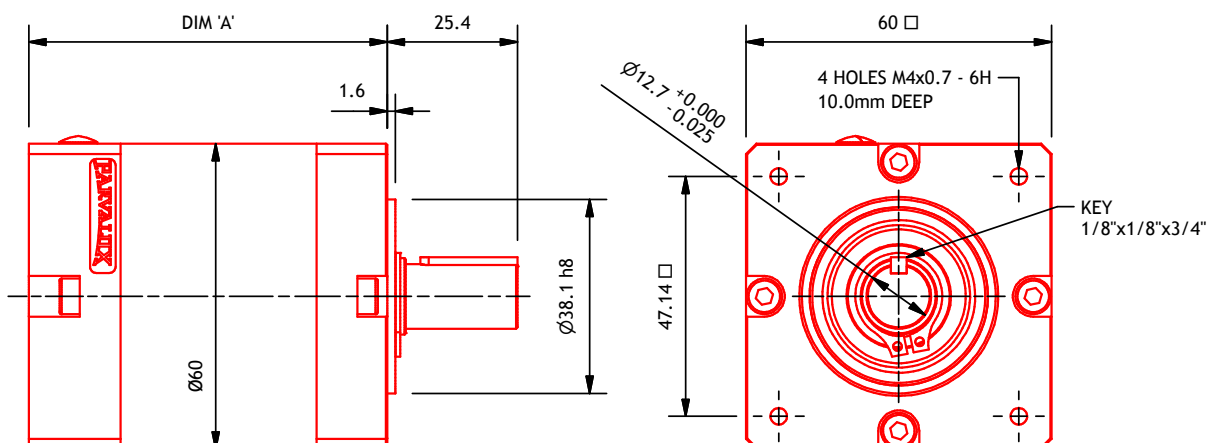

HP60 flange options 2

IEC (M56) standard flange/mount

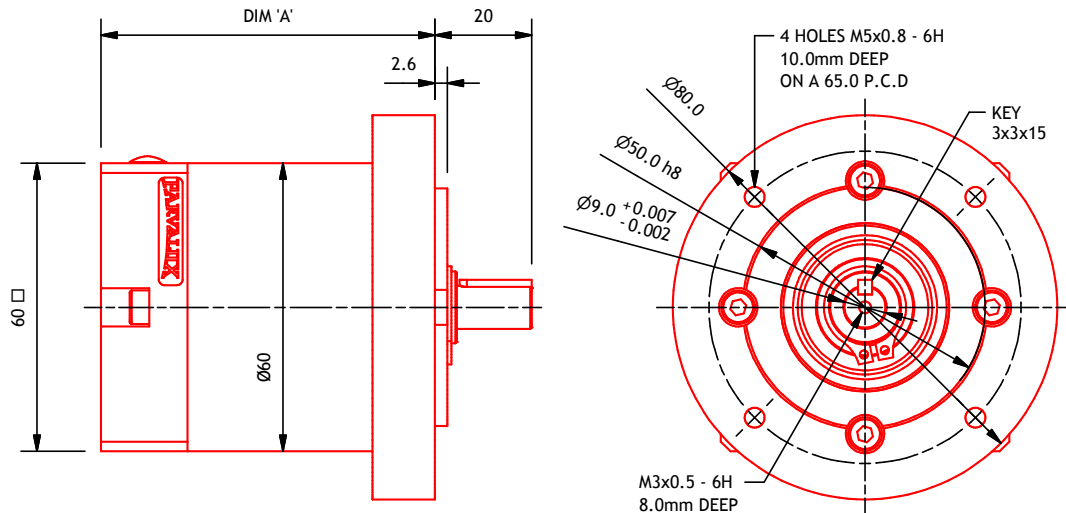

IEC (M63) standard flange/mount

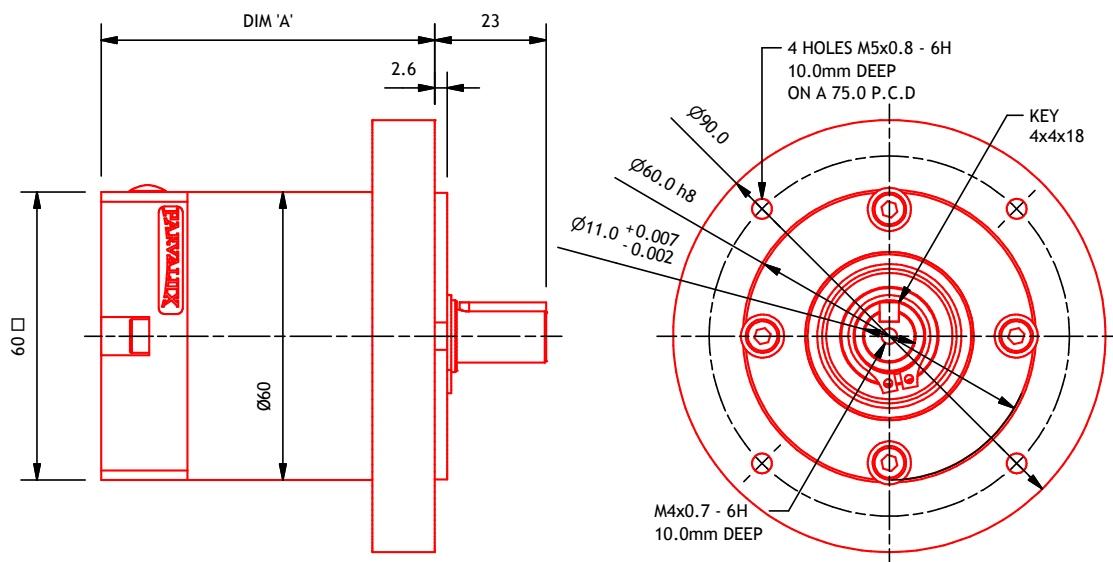

IEC (M71) standard flange/mount

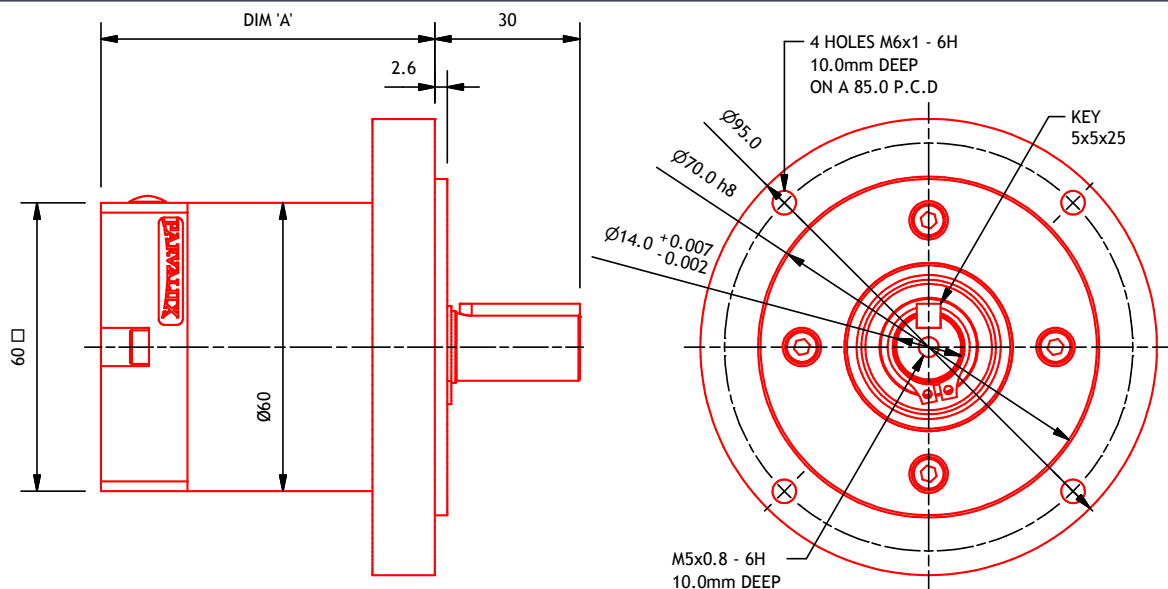

PM1HP60

MOTOR	Permanent magnet DC motor
PROTECTION	IP22
GEARBOX	Planetary HP60 (Protection IP65)
MOTOR POWER	45 - 200 Watts
SPEED	1 - 1000 rpm
VOLTAGE	12V - 220V DC available range
WEIGHT	3.13kg (ST1); 3.36kg (ST2); 3.65kg (ST3); 3.89kg (ST4)*
RADIAL LOAD	250N (ST1); 400N (ST2); 550N (ST3); 725N (ST4)*
AXIAL LOAD	75N (ST1); 125N (ST2); 175N (ST3); 225N (ST4)*
EXTRAS	See page 36 of 2009 permanent magnet catalogue



stage 1 HP60 gearbox pictured

Motor Power Cont (W)		45	60	90	120	TORQUE (Nm)		
Motor Power 1 Hour (W)		55	75	110	150			
Motor Power 15 Min (W)		75	100	150	200			
Gear Ratio	Number of stages	MOTOR SPEED (rpm)				CONTINUOUS	1 HOUR	15 MINUTE
		1500	2000	3000	4000			
		OUTPUT SPEED (rpm)						
4	1	375	500	750	1000	1.1	1.3	1.8
6	1	250	333	500	667	1.6	2	2.7
16	2	94	125	188	250	4.1	5	6.9
24	2	63	83	125	167	6.2	7.6	10.3
36	2	42	56	83	111	9.3	11.3	15
64	3	23	31	47	63	15.1	19	26
96	3	15.6	21	31	42	18.4	29	30
144	3	10.4	13.9	21	28	21	30	30
216	3	6.9	9.3	13.9	18.5	24	30	30
256	4	5.9	7.8	11.7	15.6	25	30	30
384	4	3.9	5.2	7.8	10.4	27	30	30
576	4	2.6	3.5	5.2	6.9	29	30	30
864	4	1.7	2.3	3.5	4.6	30	30	30
1296	4	1.2	1.5	2.3	3.1	30	30	30

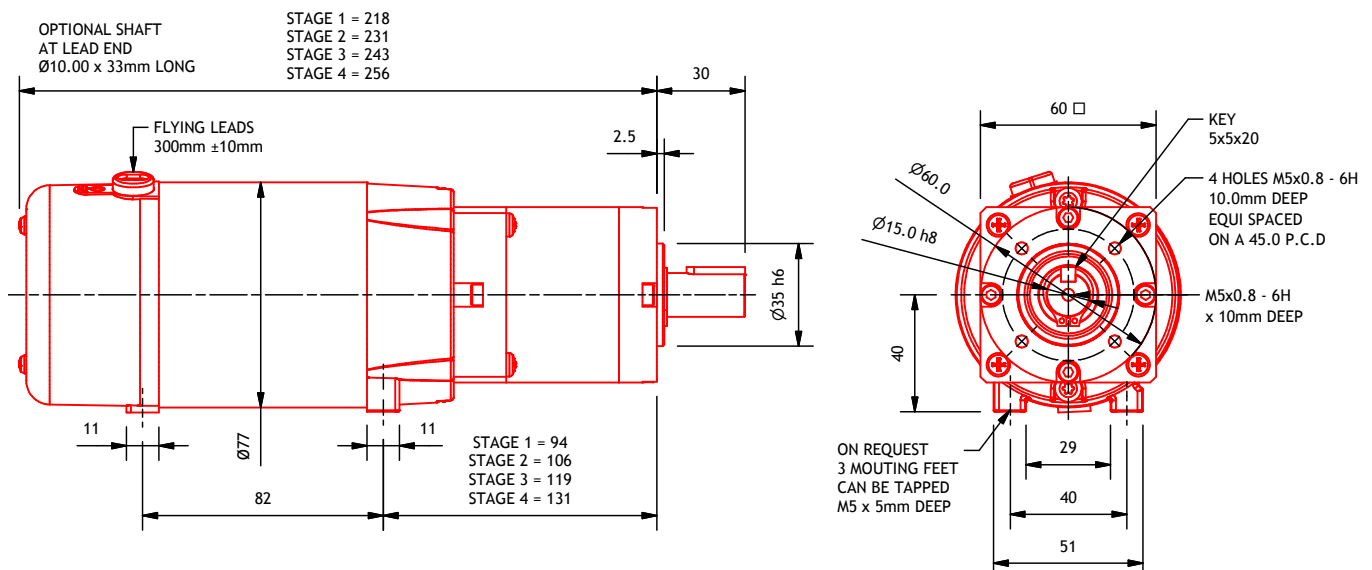

*ST = stage

PM2HP60

PARVALUX®

MOTOR	Permanent magnet DC motor
PROTECTION	IP22
GEARBOX	Planetary HP60 (Protection IP65)
MOTOR POWER	60 - 265 Watts
SPEED	1 - 1000 rpm
VOLTAGE	12V - 220V DC available range
WEIGHT	3.48kg (ST1); 3.71kg (ST2); 4.00kg (ST3); 4.24kg (ST4)*
RADIAL LOAD	250N (ST1); 400N (ST2); 550N (ST3); 725N (ST4)*
AXIAL LOAD	75N (ST1); 125N (ST2); 175N (ST3); 225N (ST4)*
EXTRAS	See page 36 of 2009 permanent magnet catalogue



stage 1 HP60 gearbox pictured

Motor Power Cont (W)		60	80	120	160	TORQUE (Nm)		
Motor Power 1 Hour (W)		75	100	150	200			
Motor Power 15 Min (W)		100	130	200	265			
Gear Ratio	Number of stages	MOTOR SPEED (rpm)				CONTINUOUS	1 HOUR	15 MINUTE
		1500	2000	3000	4000			
		OUTPUT SPEED (rpm)						
4	1	375	500	750	1000	1.5	1.8	2.4
6	1	250	333	500	667	2.2	2.7	3.6
16	2	94	125	188	250	5.5	6.9	9.2
24	2	63	83	125	167	8	10.3	13.8
36	2	42	56	83	111	10.7	15	15
64	3	23	31	47	63	15.1	26	30
96	3	15.6	21	31	42	18.4	30	30
144	3	10.4	13.9	21	28	21	30	30
216	3	6.9	9.3	13.9	18.5	24	30	30
256	4	5.9	7.8	11.7	15.6	25	30	30
384	4	3.9	5.2	7.8	10.4	27	30	30
576	4	2.6	3.5	5.2	6.9	29	30	30
864	4	1.7	2.3	3.5	4.6	30	30	30
1296	4	1.2	1.5	2.3	3.1	30	30	30

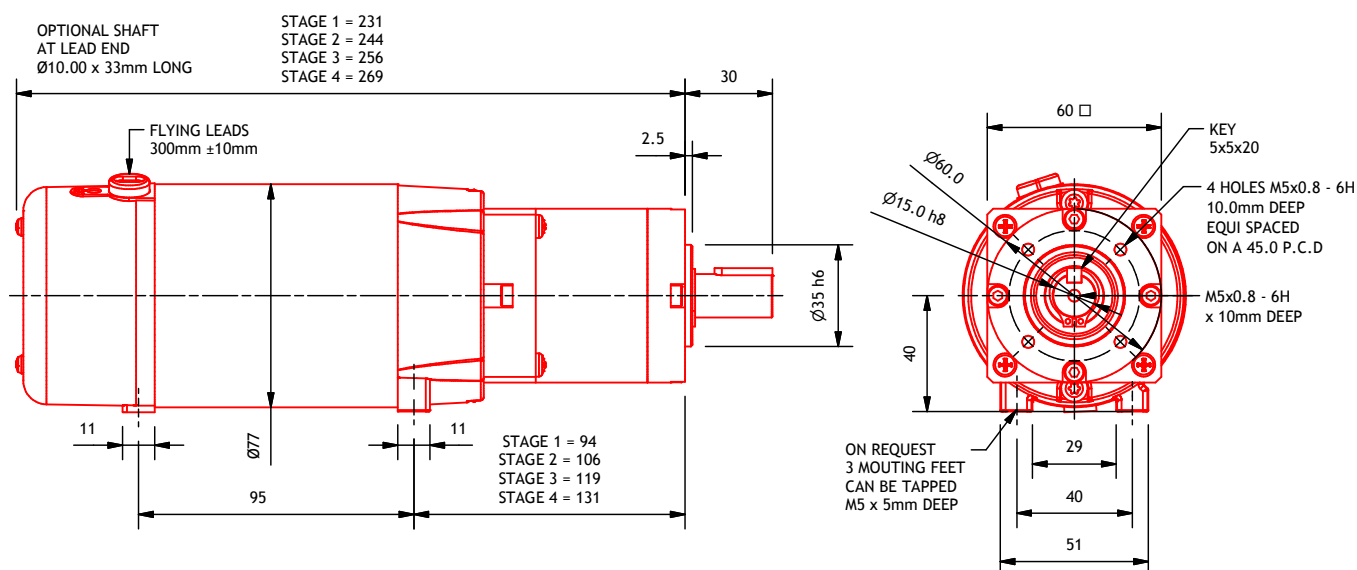

*ST = stage

PM6HP60

PARVALUX®

MOTOR	Permanent magnet DC motor
PROTECTION	IP22
GEARBOX	Planetary HP60 (Protection IP65)
MOTOR POWER	75 - 330 Watts
SPEED	1 - 1000 rpm
VOLTAGE	12V - 220V DC available range
WEIGHT	3.67kg (ST1); 3.90kg (ST2); 4.19kg (ST3); 4.43kg (ST4)*
RADIAL LOAD	250N (ST1); 400N (ST2); 550N (ST3); 725N (ST4)*
AXIAL LOAD	75N (ST1); 125N (ST2); 175N (ST3); 225N (ST4)*
EXTRAS	See page 36 of 2009 permanent magnet catalogue



stage 1 HP60 gearbox pictured

Motor Power Cont (W)		75	100	150	200	TORQUE (Nm)		
Motor Power 1 Hour (W)		90	120	180	240			
Motor Power 15 Min (W)		125	165	245	330			
Gear Ratio	Number of stages	MOTOR SPEED (rpm)				CONTINUOUS	1 HOUR	15 MINUTE
		1500	2000	3000	4000			
		OUTPUT SPEED (rpm)						
4	1	375	500	750	1000	1.8	2.2	3
6	1	250	333	500	667	2.7	3.3	4.4
16	2	94	125	188	250	5.8	8.3	11.2
24	2	63	83	125	167	8	12.4	15
36	2	42	56	83	111	10.7	15	15
64	3	23	31	47	63	15.1	30	30
96	3	15.6	21	31	42	18.4	30	30
144	3	10.4	13.9	21	28	21	30	30
216	3	6.9	9.3	13.9	18.5	24	30	30
256	4	5.9	7.8	11.7	15.6	25	30	30
384	4	3.9	5.2	7.8	10.4	27	30	30
576	4	2.6	3.5	5.2	6.9	29	30	30
864	4	1.7	2.3	3.5	4.6	30	30	30
1296	4	1.2	1.5	2.3	3.1	30	30	30

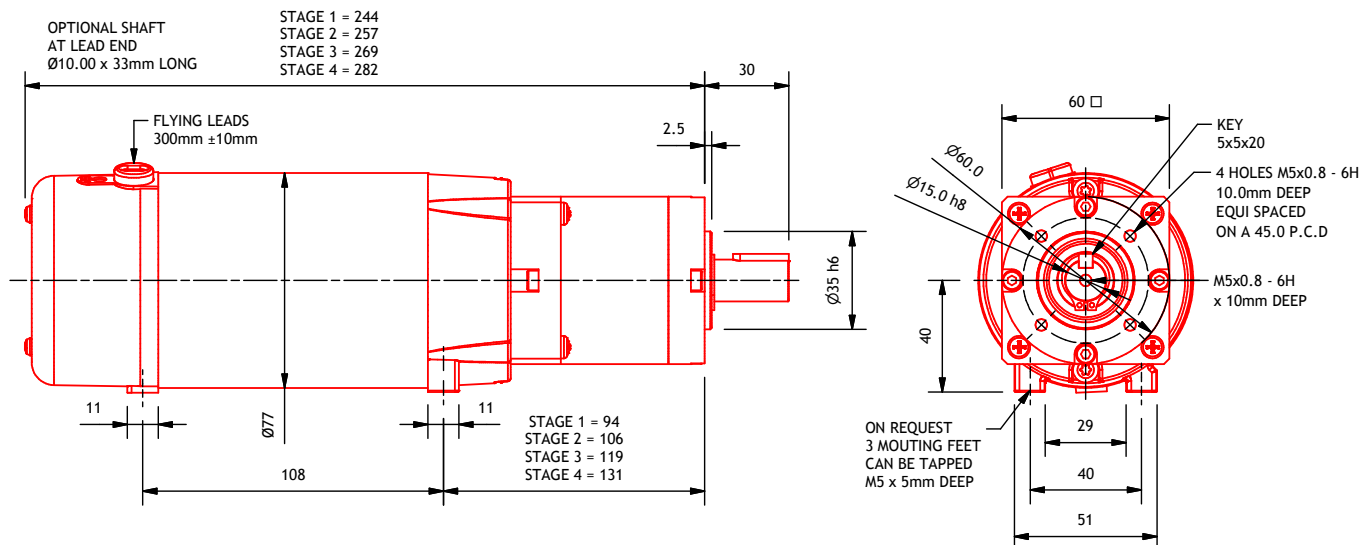

*ST = stage

PM60HP60

PARVALUX®

MOTOR	Permanent magnet DC motor
PROTECTION	IP22
GEARBOX	Planetary HP60 (Protection IP65)
MOTOR POWER	105 - 460 Watts
SPEED	1 - 1000 rpm
VOLTAGE	12V - 220V DC available range
WEIGHT	3.92kg (ST1); 4.15kg (ST2); 4.44kg (ST3); 4.68kg (ST4)*
RADIAL LOAD	250N (ST1); 400N (ST2); 550N (ST3); 725N (ST4)*
AXIAL LOAD	75N (ST1); 125N (ST2); 175N (ST3); 225N (ST4)*
EXTRAS	See page 36 of 2009 permanent magnet catalogue



stage 1 HP60 gearbox pictured

Motor Power Cont (W)		105	140	210	280	TORQUE (Nm)		
Motor Power 1 Hour (W)		128	170	255	340			
Motor Power 15 Min (W)		172	230	345	460			
Gear Ratio	Number of stages	MOTOR SPEED (rpm)				CONTINUOUS	1 HOUR	15 MINUTE
		1500	2000	3000	4000			
		OUTPUT SPEED (rpm)						
4	1	375	500	750	1000	2.5	3.1	4.2
6	1	250	333	500	667	3.8	4.6	5
16	2	94	125	188	250	5.8	11.7	15
24	2	63	83	125	167	8	15	15
36	2	42	56	83	111	10.7	15	15
64	3	23	31	47	63	15.1	30	30
96	3	15.6	21	31	42	18.4	30	30
144	3	10.4	13.9	21	28	21	30	30
216	3	6.9	9.3	13.9	18.5	24	30	30
256	4	5.9	7.8	11.7	15.6	25	30	30
384	4	3.9	5.2	7.8	10.4	27	30	30
576	4	2.6	3.5	5.2	6.9	29	30	30
864	4	1.7	2.3	3.5	4.6	30	30	30
1296	4	1.2	1.5	2.3	3.1	30	30	30

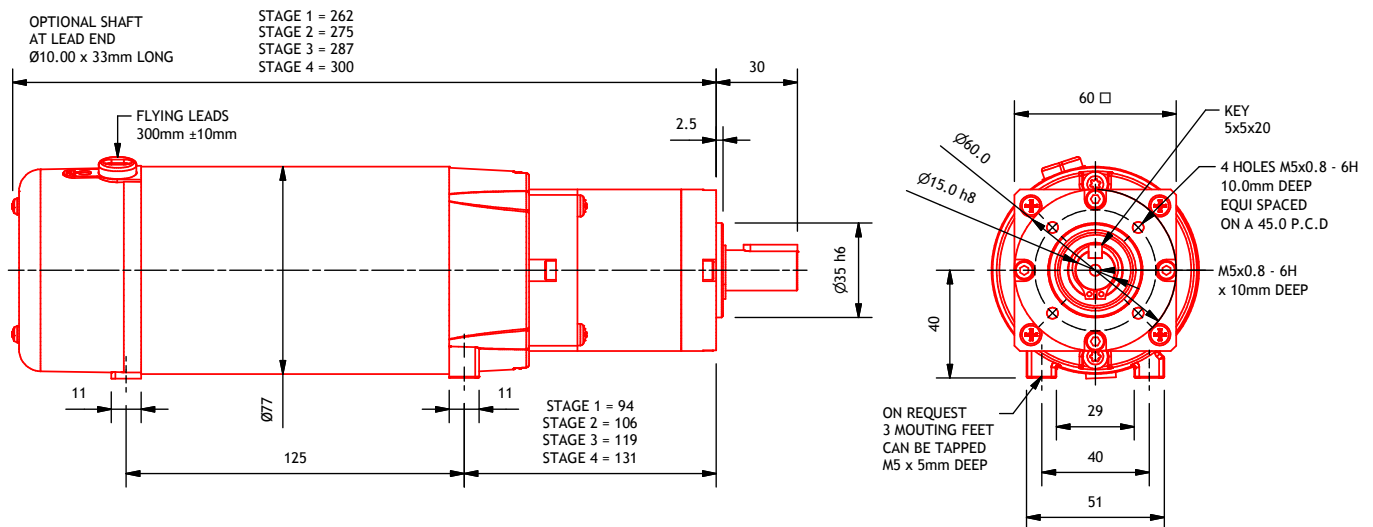

*ST = stage

PM10HP60

MOTOR	Permanent magnet DC motor
PROTECTION	IP54
GEARBOX	Planetary HP60 (Protection IP65)
MOTOR POWER	23 - 100 Watts
SPEED	0.6 - 1000 rpm
VOLTAGE	12V - 220V DC available range
WEIGHT	2.14kg (ST1); 2.37kg (ST2); 2.66kg (ST3); 2.90kg (ST4)*
RADIAL LOAD	250N (ST1); 400N (ST2); 550N (ST3); 725N (ST4)*
AXIAL LOAD	75N (ST1); 125N (ST2); 175N (ST3); 225N (ST4)*
EXTRAS	See page 36 of 2009 permanent magnet catalogue



stage 1 HP60 gearbox pictured

Motor Power Cont (W)		23	30	45	60	TORQUE (Nm)		
Motor Power 1 Hour (W)		28	38	55	75			
Motor Power 15 Min (W)		35	50	70	100			
Gear Ratio	Number of stages	MOTOR SPEED (rpm)				CONTINUOUS	1 HOUR	15 MINUTE
		1500	2000	3000	4000			
		OUTPUT SPEED (rpm)						
4	1	375	500	750	1000	0.5	0.7	0.8
6	1	250	333	500	667	0.8	1	1.3
16	2	94	125	188	250	2.1	2.5	3.2
24	2	63	83	125	167	3.1	3.8	4.8
36	2	42	56	83	111	4.6	5.7	7.2
64	3	23	31	47	63	7.8	9.5	12.1
96	3	15.6	21	31	42	11.7	14.3	18.2
144	3	10.4	13.9	21	28	17.5	21	27
216	3	6.9	9.3	13.9	18.5	24	30	30
256	4	5.9	7.8	11.7	15.6	25	30	30
384	4	3.9	5.2	7.8	10.4	27	30	30
576	4	2.6	3.5	5.2	6.9	29	30	30
864	4	1.7	2.3	3.5	4.6	30	30	30
1296	4	1.2	1.5	2.3	3.1	30	30	30

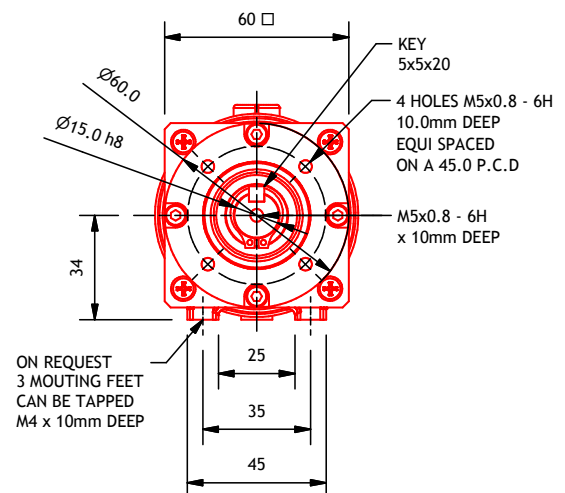
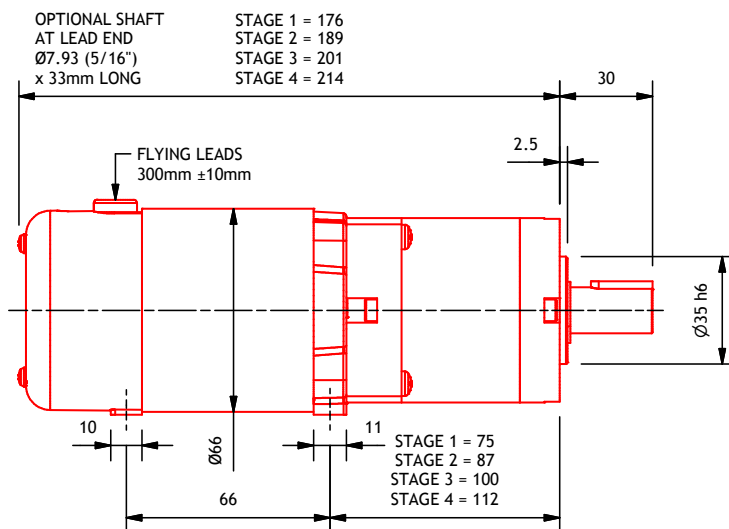

PM11HP60

PARVALUX®

MOTOR	Permanent magnet DC motor
PROTECTION	IP54
GEARBOX	Planetary HP60 (Protection IP65)
MOTOR POWER	33 - 130 Watts
SPEED	1 - 1000 rpm
VOLTAGE	12V - 220V DC available range
WEIGHT	2.60kg (ST1); 2.83kg (ST2); 3.12kg (ST3); 3.36kg (ST4)*
RADIAL LOAD	250N (ST1); 400N (ST2); 550N (ST3); 725N (ST4)*
AXIAL LOAD	75N (ST1); 125N (ST2); 175N (ST3); 225N (ST4)*
EXTRAS	See page 36 of 2009 permanent magnet catalogue



stage 1 HP60 gearbox pictured

Motor Power Cont (W)		33	45	65	90	TORQUE (Nm)		
Motor Power 1 Hour (W)		40	55	80	110			
Motor Power 15 Min (W)		50	65	100	130			
Gear Ratio	Number of stages	MOTOR SPEED (rpm)				CONTINUOUS	1 HOUR	15 MINUTE
		1500	2000	3000	4000			
		OUTPUT SPEED (rpm)						
4	1	375	500	750	1000	0.8	1	1.2
6	1	250	333	500	667	1.2	1.5	1.8
16	2	94	125	188	250	3	3.7	4.6
24	2	63	83	125	167	4.5	5.5	6.9
36	2	42	56	83	111	6.7	8.3	10.3
64	3	23	31	47	63	11.3	13.9	17.3
96	3	15.6	21	31	42	16.9	21	26
144	3	10.4	13.9	21	28	21	30	30
216	3	6.9	9.3	13.9	18.5	24	30	30
256	4	5.9	7.8	11.7	15.6	25	30	30
384	4	3.9	5.2	7.8	10.4	27	30	30
576	4	2.6	3.5	5.2	6.9	29	30	30
864	4	1.7	2.3	3.5	4.6	30	30	30
1296	4	1.2	1.5	2.3	3.1	30	30	30

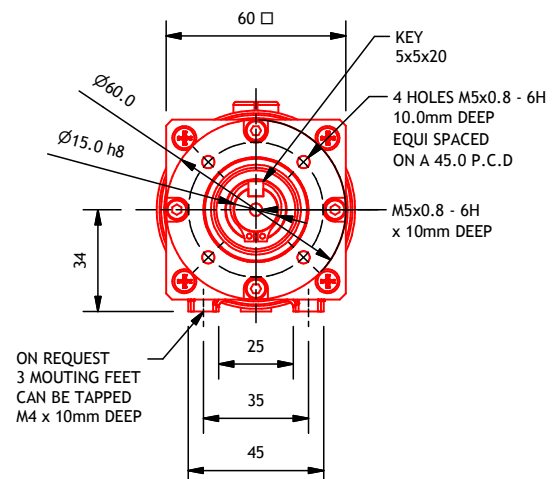
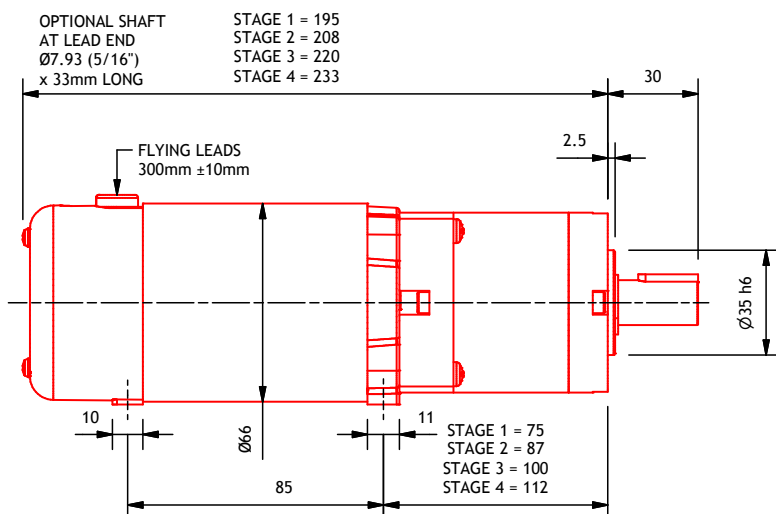

*ST = stage

PM3HP60

PARVALUX®

MOTOR	Permanent magnet DC motor
PROTECTION	IP54
GEARBOX	Planetary HP60 (Protection IP65)
MOTOR POWER	33 - 150 Watts
SPEED	1 - 1000 rpm
VOLTAGE	12V - 220V DC available range
WEIGHT	3.13kg (ST1); 3.36kg (ST2); 3.65kg (ST3); 3.89kg (ST4)*
RADIAL LOAD	250N (ST1); 400N (ST2); 550N (ST3); 725N (ST4)*
AXIAL LOAD	75N (ST1); 125N (ST2); 175N (ST3); 225N (ST4)*
EXTRAS	See page 36 of 2009 permanent magnet catalogue



stage 1 HP60 gearbox pictured

Motor Power Cont (W)		33	45	68	90	TORQUE (Nm)		
Motor Power 1 Hour (W)		45	60	90	120			
Motor Power 15 Min (W)		60	90	120	150			
Gear Ratio	Number of stages	MOTOR SPEED (rpm)				CONTINUOUS	1 HOUR	15 MINUTE
		1500	2000	3000	4000			
		OUTPUT SPEED (rpm)						
4	1	375	500	750	1000	0.8	1.1	1.5
6	1	250	333	500	667	1.2	1.6	2.2
16	2	94	125	188	250	3.1	4.1	5.5
24	2	63	83	125	167	4.7	6.2	8.3
36	2	42	56	83	111	7	9.3	12.4
64	3	23	31	47	63	11.8	15.6	21
96	3	15.6	21	31	42	17.7	23	30
144	3	10.4	13.9	21	28	21	30	30
216	3	6.9	9.3	13.9	18.5	24	30	30
256	4	5.9	7.8	11.7	15.6	25	30	30
384	4	3.9	5.2	7.8	10.4	27	30	30
576	4	2.6	3.5	5.2	6.9	29	30	30
864	4	1.7	2.3	3.5	4.6	30	30	30
1296	4	1.2	1.5	2.3	3.1	30	30	30

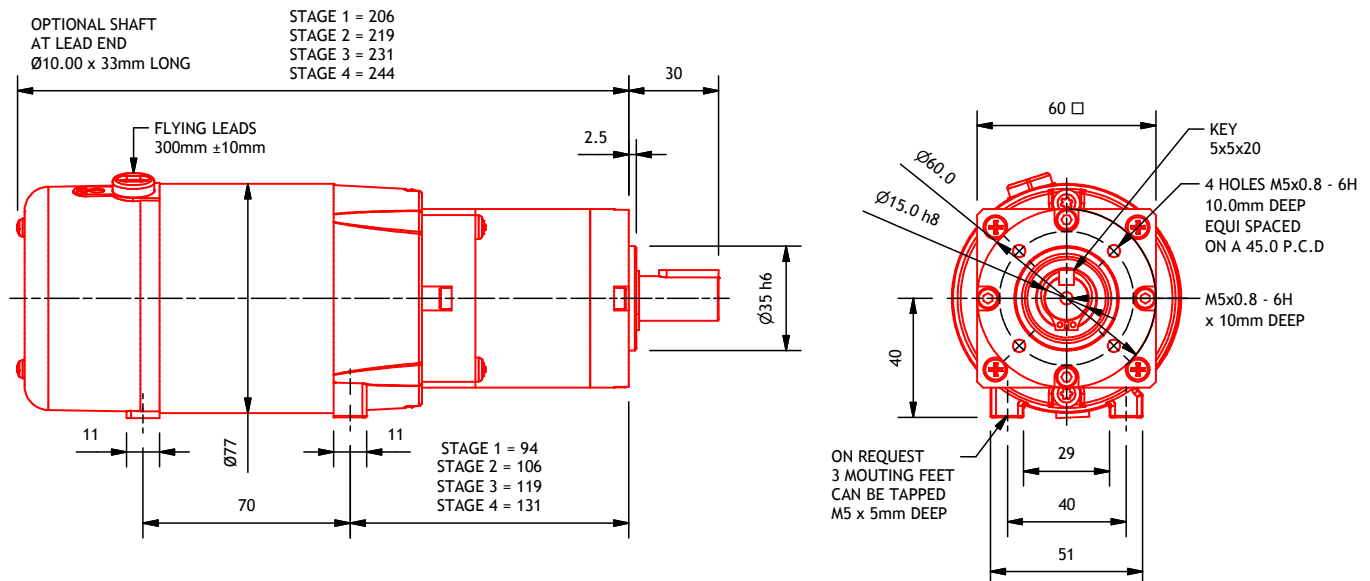

*ST = stage

PM4HP60

PARVALUX®

MOTOR	Permanent magnet DC motor
PROTECTION	IP54
GEARBOX	Planetary HP60 (Protection IP65)
MOTOR POWER	45 - 200 Watts
SPEED	1 - 1000 rpm
VOLTAGE	12V - 220V DC available range
WEIGHT	3.48kg (ST1); 3.71kg (ST2); 4.00kg (ST3); 4.24kg (ST4)*
RADIAL LOAD	250N (ST1); 400N (ST2); 550N (ST3); 725N (ST4)*
AXIAL LOAD	75N (ST1); 125N (ST2); 175N (ST3); 225N (ST4)*
EXTRAS	See page 36 of 2009 permanent magnet catalogue



stage 1 HP60 gearbox pictured

Motor Power Cont (W)		45	60	90	120	TORQUE (Nm)		
Motor Power 1 Hour (W)		60	80	120	160			
Motor Power 15 Min (W)		80	120	160	200			
Gear Ratio	Number of stages	MOTOR SPEED (rpm)				CONTINUOUS	1 HOUR	15 MINUTE
		1500	2000	3000	4000			
OUTPUT SPEED (rpm)								
4	1	375	500	750	1000	1.1	1.5	1.9
6	1	250	333	500	667	1.6	2.2	2.9
16	2	94	125	188	250	4.1	5.5	7.3
24	2	63	83	125	167	6.2	8.3	11
36	2	42	56	83	111	9.3	12.4	15
64	3	23	31	47	63	15.1	21	28
96	3	15.6	21	31	42	18.4	30	30
144	3	10.4	13.9	21	28	21	30	30
216	3	6.9	9.3	13.9	18.5	24	30	30
256	4	5.9	7.8	11.7	15.6	25	30	30
384	4	3.9	5.2	7.8	10.4	27	30	30
576	4	2.6	3.5	5.2	6.9	29	30	30
864	4	1.7	2.3	3.5	4.6	30	30	30
1296	4	1.2	1.5	2.3	3.1	30	30	30

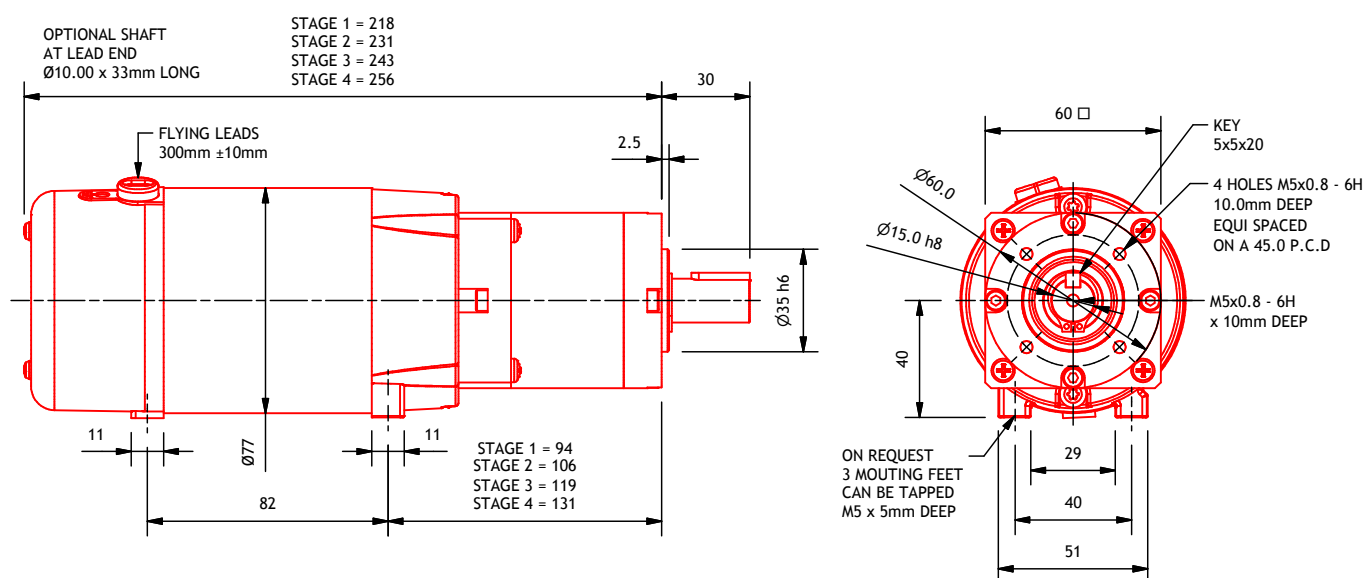

*ST = stage

PM5HP60

MOTOR	Permanent magnet DC motor
PROTECTION	IP54
GEARBOX	Planetary HP60 (Protection IP65)
MOTOR POWER	60 - 250 Watts
SPEED	1 - 1000 rpm
VOLTAGE	12V - 220V DC available range
WEIGHT	3.67kg (ST1); 3.90kg (ST2); 4.19kg (ST3); 4.43kg (ST4)*
RADIAL LOAD	250N (ST1); 400N (ST2); 550N (ST3); 725N (ST4)*
AXIAL LOAD	75N (ST1); 125N (ST2); 175N (ST3); 225N (ST4)*
EXTRAS	See page 36 of 2009 permanent magnet catalogue



stage 1 HP60 gearbox pictured

Motor Power Cont (W)		60	80	120	160	TORQUE (Nm)		
Motor Power 1 Hour (W)		75	100	150	200			
Motor Power 15 Min (W)		100	150	200	250			
Gear Ratio	Number of stages	MOTOR SPEED (rpm)				CONTINUOUS	1 HOUR	15 MINUTE
		1500	2000	3000	4000			
		OUTPUT SPEED (rpm)						
4	1	375	500	750	1000	1.5	1.8	2.4
6	1	250	333	500	667	2.2	2.7	3.6
16	2	94	125	188	250	5.5	6.9	9.2
24	2	63	83	125	167	8	10.3	13.8
36	2	42	56	83	111	10.7	15	15
64	3	23	31	47	63	15.1	26	30
96	3	15.6	21	31	42	18.4	30	30
144	3	10.4	13.9	21	28	21	30	30
216	3	6.9	9.3	13.9	18.5	24	30	30
256	4	5.9	7.8	11.7	15.6	25	30	30
384	4	3.9	5.2	7.8	10.4	27	30	30
576	4	2.6	3.5	5.2	6.9	29	30	30
864	4	1.7	2.3	3.5	4.6	30	30	30
1296	4	1.2	1.5	2.3	3.1	30	30	30

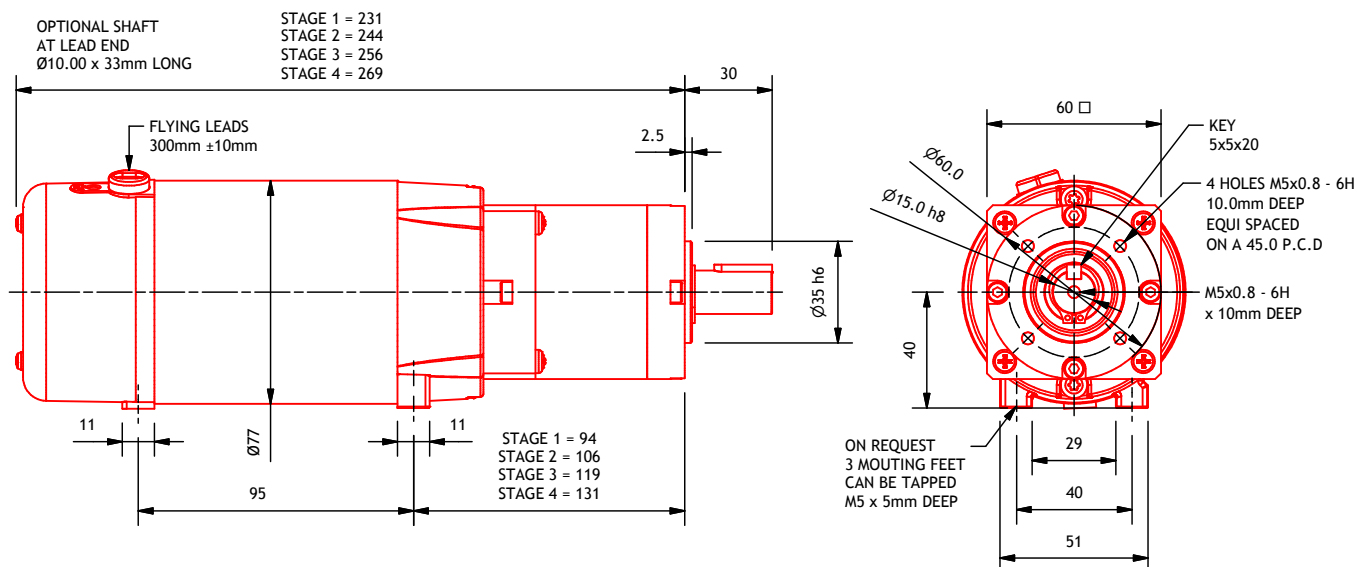

*ST = stage

PM50HP60

MOTOR	Permanent magnet DC motor
PROTECTION	IP54
GEARBOX	Planetary HP60 (Protection IP65)
MOTOR POWER	80 - 375 Watts
SPEED	1 - 1000 rpm
VOLTAGE	12V - 220V DC available range
WEIGHT	3.92kg (ST1); 4.15kg (ST2); 4.44kg (ST3); 4.68kg (ST4)*
RADIAL LOAD	250N (ST1); 400N (ST2); 550N (ST3); 725N (ST4)*
AXIAL LOAD	75N (ST1); 125N (ST2); 175N (ST3); 225N (ST4)*
EXTRAS	See page 36 of 2009 permanent magnet catalogue



stage 1 HP60 gearbox pictured

Motor Power Cont (W)		80	105	155	205	TORQUE (Nm)		
Motor Power 1 Hour (W)		100	135	200	265			
Motor Power 15 Min (W)		140	185	280	375			
Gear Ratio	Number of stages	MOTOR SPEED (rpm)				CONTINUOUS	1 HOUR	15 MINUTE
		1500	2000	3000	4000			
		OUTPUT SPEED (rpm)						
4	1	375	500	750	1000	1.9	2.4	3.4
6	1	250	333	500	667	2.8	3.6	5
16	2	94	125	188	250	5.8	9.2	12.8
24	2	63	83	125	167	8	13.8	15
36	2	42	56	83	111	10.7	15	15
64	3	23	31	47	63	15.1	30	30
96	3	15.6	21	31	42	18.4	30	30
144	3	10.4	13.9	21	28	21	30	30
216	3	6.9	9.3	13.9	18.5	24	30	30
256	4	5.9	7.8	11.7	15.6	25	30	30
384	4	3.9	5.2	7.8	10.4	27	30	30
576	4	2.6	3.5	5.2	6.9	29	30	30
864	4	1.7	2.3	3.5	4.6	30	30	30
1296	4	1.2	1.5	2.3	3.1	30	30	30

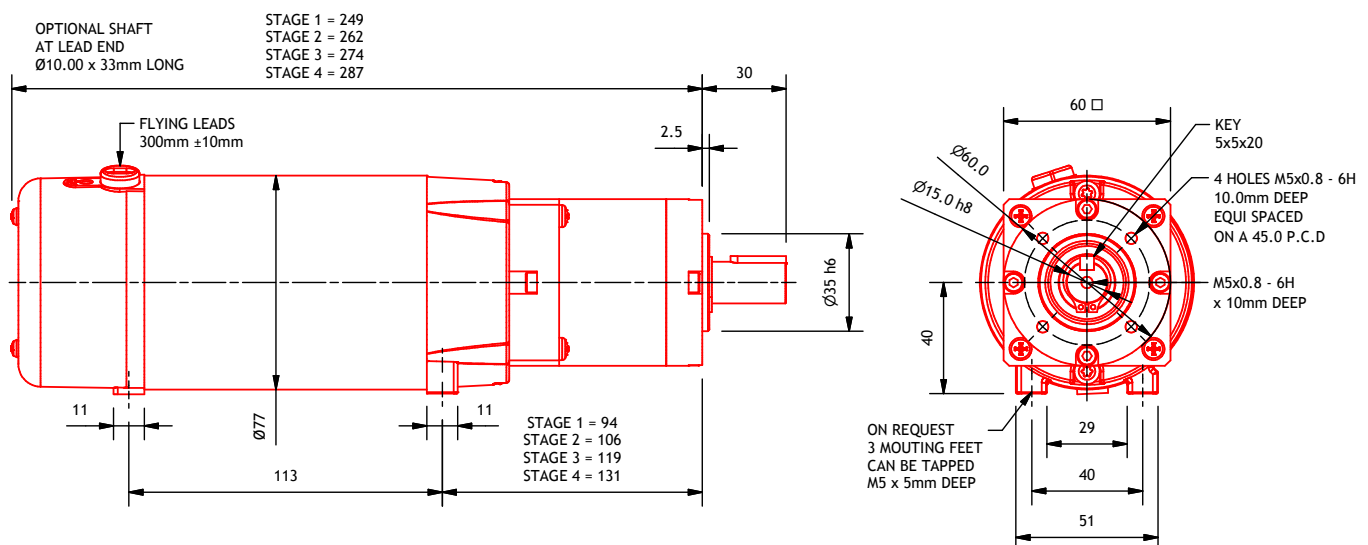

*ST = stage

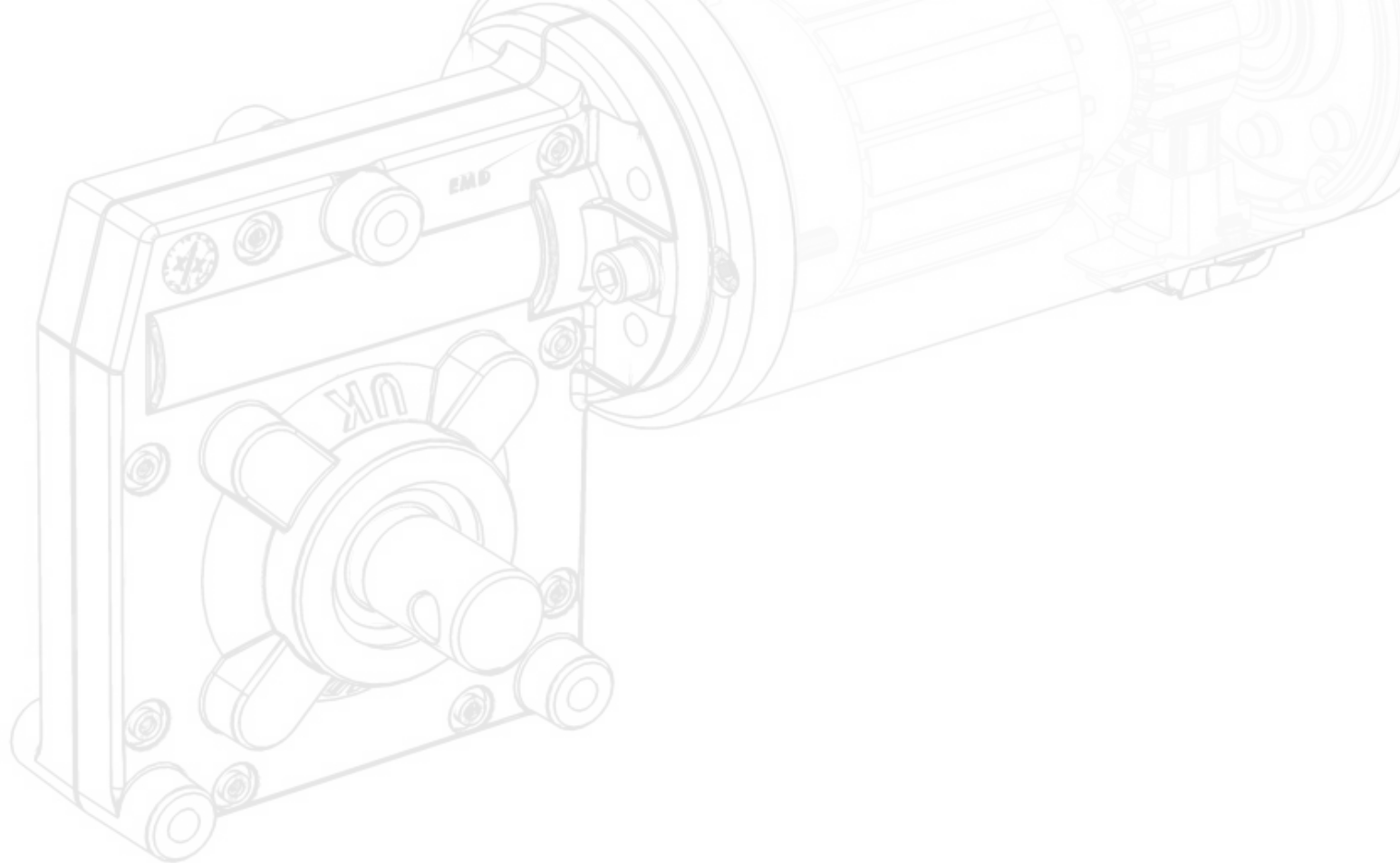

Worldwide approved distributor network

Australia

Eastland Electric Motors
www.au.parvalux.com

Austria

Kwapil & Co
www.kwapil.com

China

Euro-Me
www.euro-me.com

Colombia

Inpraindsa
www.inpraindsa.com

Denmark

Parlock
www.parlock.dk

Ireland

Rotate-Brammer
www.rotate.ie

India

Melkev Machinery
www.melkev.com

Italy

Log-Italia
www.log-italia.it

Hungary

Q-Tech Engineering
www.q-tech.hu

Spain

Ermec
www.ermec.com

Sweden

SDT
www.sdt.se

Switzerland

Electro-Müller
www.electro-mueller.ch

United Kingdom

Brammer
www.brammer.biz

United Kingdom

RS Components
www.rswww.com

Parvalux International HQ

490 Wallisdown Road
 Bournemouth BH11 8PU
 United Kingdom
 T :: +44 120 251 2575
 F :: +44 120 253 0885
 E :: sales@parvalux.com

Parvalux Birmingham

Unit 4, 26 Avenue Road
 Birmingham B6 4DY
 United Kingdom
 T :: +44 800 917 7155
 F :: +44 121 333 5966
 E :: sales@parvalux.com

Parvalux New York

18 Blooms Corners Road
 Warwick 10990
 United States
 T :: +1 845 258 7482
 F :: +1 845 986 2130
 E :: sales@parvalux.com

Parvalux Frankfurt

Egertshammer 1
 D-61276 Weilrod,
 Altweilnau, Germany
 T :: +49 6083 958 870
 F :: +49 6083 958 872
 E :: info@parvalux.de

Parvalux Paris

4 rue Guynemer
 Guyancourt 78280
 France
 T :: +33 130 437 273
 F :: +33 130 441 063
 E :: parvalux@parvalux.fr

Parvalux Warsaw

al. Niepodleglosci 186
 00-608 Warszawa
 Poland
 T :: +48 22 629 7348
 F :: +48 22 244 2481
 E :: parvalux@parvalux.pl

Parvalux Johannesburg

132 Leicester Road
 Johannesburg 2094
 South Africa
 T :: +27 11 622 6826
 F :: +27 11 622 6823
 E :: info@parvalux.co.za

www.parvalux.com

PARVALUX®